

# Zimbra Retention setup

aka disposal of the old emails

## Setup via web client

Log into zimbra web client <https://mail.cerge-ei.cz>

Rigth click folder → Edit Properties

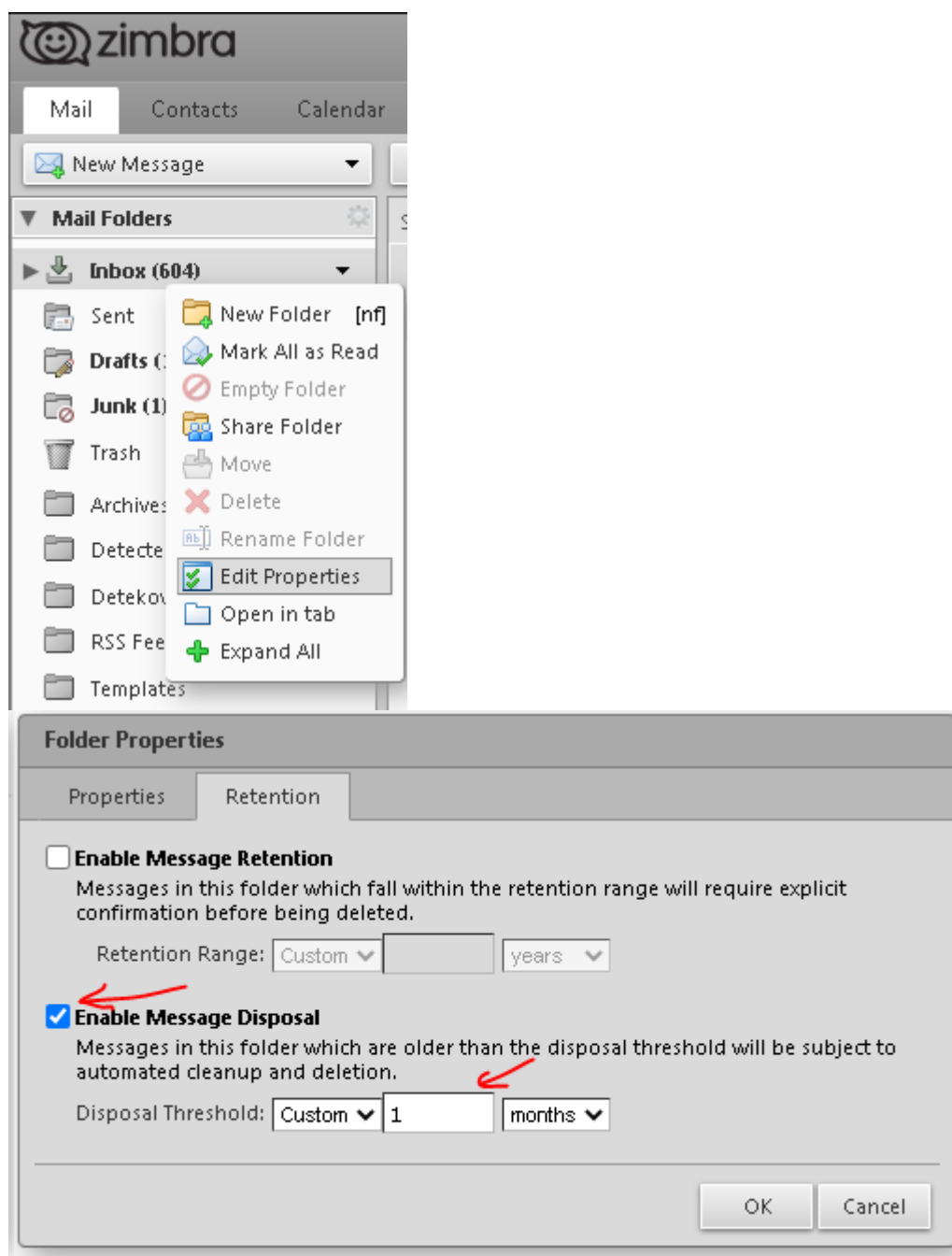

From:  
<https://wiki.cerge-ei.cz/> - **CERGE-EI Infrastructure Services**

Permanent link:  
[https://wiki.cerge-ei.cz/doku.php?id=public:emai:zimbra\\_retention&rev=1615372897](https://wiki.cerge-ei.cz/doku.php?id=public:emai:zimbra_retention&rev=1615372897)

Last update: **2021-03-10 10:41**

